



Mule TPM250E Electric Tracked Barrow



Operator's Manual

IMPORTANT SAFETY INFORMATION

- Failure to follow the instructions in this manual may result in serious injury, death, or damage to the machine.
- This machine is designed solely for transporting materials. Any other use is prohibited. Carrying passengers is strictly forbidden.
- This machine is not road legal and must not be used on public roads or highways.
- Do not modify or alter the machine in any way. All safety guards and covers must remain securely in place during operation.
- The manufacturer assumes no liability for damage to the machine, property, or injury to persons or animals caused by failure to comply with the terms above. Additionally, failure to follow these terms will void any applicable warranty.

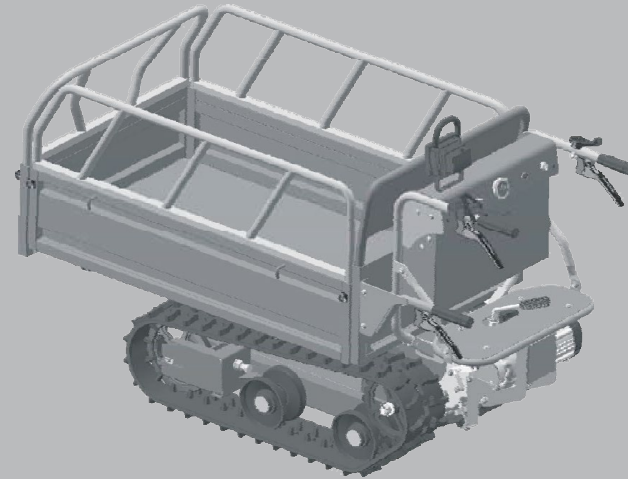

Mule TPM250E - FOREWORD

Thank you for purchasing the Mule TPM250E Tracked Barrow.

- **Scope:** This manual covers the safe operation and maintenance of the Mule TPM250E.
- **Accuracy:** The information contained in this publication is based on the latest technical data available at the time of printing.
- **Modifications:** The manufacturer reserves the right to change the content of this manual or the product specifications at any time without notice or obligation. Consequently, the actual product may differ slightly from the illustrations or descriptions found in this manual.
- **Copyright:** This manual may not be reproduced, in whole or in part, without prior written approval.
- **Resale:** This manual should be considered a permanent part of the machine and must remain with the Mule TPM250E if resold or transferred to a new owner.
- **Manufacturing Standard:** JB/T 10266-2013
- **Motor Certification No:** XK06-002-00252

INTRODUCTION

About This Manual Please read this manual carefully before operating the machine.

It contains important information regarding the safe operation and maintenance of the Mule TPM250E.

Safety Symbols & Signal Words This manual uses the following safety symbols and signal words to alert you to potential hazards. Please pay close attention to these sections to avoid injury or damage to the machine.

⚠ **DANGER:** Indicates an immediate hazard which, if not avoided, will result in death or serious injury.

⚠ **WARNING:** Indicates a potential hazard which, if not avoided, could result in death or serious injury.

⚠ **CAUTION:** Indicates a potential hazard which, if not avoided, could result in minor or moderate injury, or damage to the machine.

NOTICE: Information that is important for proper machine operation but is not related to physical injury (e.g., messages regarding property damage).

OPERATIONAL SAFETY



General Safety: Operating the machine according to these instructions ensures reliability and safety. Read this manual thoroughly to prevent injury to yourself or damage to the equipment.

Pre-Start Safety Checks Before starting the machine, perform the following checks:

- **Visual Inspection:** Ensure all parts are present, secure, and in good condition.
- **Wiring:** Check all wiring for damage or potential short circuits.
- **Fluids:** Ensure all oil and lubricant levels are correct.
- **Work Area:** Do not allow bystanders or animals to stand in the operating area while the machine is running.

Operating Guidelines

- **Starting:** Set the throttle switch to the minimum (upright) position before starting the motor. Once the motor is running, engage the clutch slowly to begin moving.
- **Shifting Gears:** Always disengage (release) the clutch before shifting gears. The machine must come to a complete stop before changing gears.

Disclaimer: The images in this manual may differ slightly from your physical machine due to continuous product improvements.

TABLE OF CONTENTS

1. SAFETY INSTRUCTIONS	Page 01
• 1.1 Training	Page 01
• 1.2 Preparation	Page 01
• 1.3 Operation	Page 01
• 1.4 Loading & Transport	Page 02
• 1.5 Operating on Slopes	Page 02
• 1.6 Maintenance and Repair Safety	Page 02
• 1.7 Storage Safety	Page 02
• 1.8 Safety Symbols	Page 03
2. SPECIFICATIONS & OVERVIEW	
• 2.1 Technical Specifications	Page 04
• 2.2 Machine Components	Page 05
• 2.3 Controls Overview	Page 06
• 2.4 Circuit Diagram	Page 07
3. INTENDED USE	Page 07
4. ASSEMBLY	Page 08
4.1 Unpacking	Page 08
4.2 Assembly Instructions	Page 09
5. OPERATING INSTRUCTIONS	Page 11
5.1 Pre-Start Checks	Page 11
5.2 Starting	Page 11
5.3 Operation	Page 12
6. MAINTENANCE	Page 14
6.1 Routine Inspection	Page 14
6.2 Transmission Oil Change	Page 15
7. TROUBLESHOOTING	Page 16
8. TRANSPORT & STORAGE	Page 17
8.1 Transporting the Machine	Page 17
8.2 Storage	Page 17
9. WEAR PARTS LIST	Page 19

CUSTOMER SUPPORT & RESOURCES

Need help with your Mule TPM250E? We offer a comprehensive online support center to ensure you get the most out of your machine. Please visit our website for the following resources:

- **Instructional Videos:** Step-by-step guides on assembly, operation, and maintenance.
- **Spare Parts:** Order official replacement parts directly from our store.
- **Technical Information:** Download digital copies of manuals and technical diagrams.
- **FAQs:** Answers to common questions and troubleshooting tips.
- **Aftersales Care:** Contact our support team for warranty and service enquiries.

VISIT OUR ONLINE SUPPORT CENTER

[CLICK HERE TO VISIT WEBSITE](https://www.titan-pro.co.uk/)

<https://www.titan-pro.co.uk/>

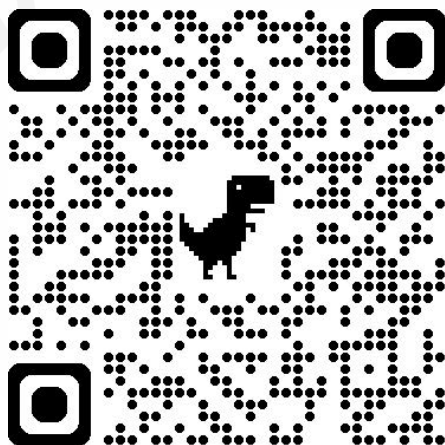

1. SAFETY INSTRUCTIONS

1.1 Training

- **Read the Manual:** Read and understand this entire manual before operating the machine. Ensure you are fully familiar with the controls and know how to stop the machine quickly in an emergency.
- **Age Restriction:** Operators must be competent adults. Children are strictly prohibited from operating this machine.
- **Bystanders:** Keep the operating area clear of all persons, children, and pets.

1.2 Preparation

- **Site Inspection:** Clear the working path of debris, large rocks, and obstacles before starting work. Do not use the machine on slippery surfaces.
- **Hardware Check:** Inspect nuts, bolts, and fasteners for tightness before every use. Ensure torque settings are correct.
- **Protective Gear (PPE):** Always wear suitable protective clothing, including non-slip footwear. Do not wear loose clothing, jewelry, or long hair that could become entangled in moving parts.
- **Sobriety:** Do not operate this machine while under the influence of alcohol, drugs, or medication that impairs reaction time.
- **Machine Check:** Inspect the machine before every use. Check all circuitry, wiring, and fluid levels.
- **Modifications:** Do not modify the motor, chassis, or safety guards. Unauthorized modifications may compromise safety and will void the warranty.

1.3 Operation

- **Starting:** Ensure the speed switch is set to the minimum/slow position before starting.
- **Smooth Operation:** Avoid sudden starts, stops, or turns. Operate the controls smoothly to maintain stability.
- **Reversing:** Always check your surroundings and look behind you before engaging reverse gear.
- **Speed Control:** Adjust your speed to match the terrain. Always reduce speed on uneven ground or in poor weather conditions.
- **Vibration:** If the machine starts to vibrate abnormally, stop the motor immediately. Inspect for damage or loose parts before restarting.
- **Shifting Gears:** Stop the machine and release the clutch before changing gears. Never change gear while the machine is moving.
- **Stopping:** To safely stop the machine:
 1. Release the clutch.
 2. Reduce speed to the minimum position.
 3. Turn off the motor and remove the key.

1.4 Loading & Transport

- Do Not Overload: Never exceed the rated load capacity of the machine.
- Secure the Load: Ensure all materials are securely loaded. Do not stack materials so high that they block your vision or affect stability.
- No Passengers: Do not carry passengers on the machine or in the transport bucket.

1.5 Operating on Slopes

Maximum Gradient

- Slopes up to 15°: Maximum load is 220kg.
- Slopes over 20°: The machine must be EMPTY. Do not carry a load.

Slope Safety

- Speed: Always use the slowest speed when operating on a slope.
- No Turning: Do not turn the machine while on a slope; this can cause it to tip over.
- No Gear Changes: Select the correct gear before starting the slope. Do not change gears while on the slope.
- No Tipping: Do not attempt to tip (dump) the load while on a slope. Perform dumping operations on flat ground only.
- Do Not Stop: Avoid stopping the machine on an incline.
- NOTICE: SLOPE LIMITS While the machine is mechanically capable of climbing inclines up to 30°, for safety and stability, do not exceed a 20° gradient during regular operation, especially when carrying a load.

1.6 Maintenance & Repair Safety

- Power Off: Ensure the machine is turned off securely and the key is removed before performing any maintenance, cleaning, or repairs.
- Tools: Always use the correct tools for assembly and maintenance to prevent damage to the machine or personal injury.
- Cleaning: Do not use high-pressure water to clean internal components or electrical parts (motor, wiring, control box).

1.7 Storage Safety

- Location: Store the machine in a safe, secure, and dry location away from children.
- Long-Term Storage: If the machine will be stored for a long period, ensure this manual is kept in a safe place where it can be easily located for future use.

1.8 Safety Symbols

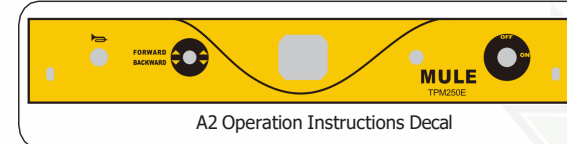

1. Keep Decals Clean: Ensure all safety labels and warning signs are clean, legible, and clearly visible at all times.
2. Replace Damaged Decals: If any safety labels are missing, damaged, or unreadable, contact the manufacturer immediately to order replacements. Refer to the diagram below to ensure new decals are applied in the correct locations.

Safety Decal Placement Guide

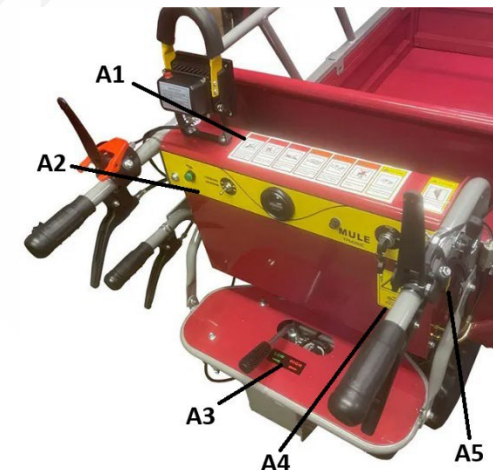

2. SPECIFICATIONS & OVERVIEW

2.1 Technical Specifications

Note: The manufacturer reserves the right to change specifications without notice. Actual product parameters may vary slightly.

Category	Item	Specification
Dimensions & Weight	Model	Mule TPM250E
	Condition	New
	Colour	Red
	Machine Weight	220 kg
	Rated Load Capacity	220 kg
	Maximum Load Capacity	450 kg
	Assembled Dimensions	1540 mm (L) x 700 mm (W) x 1100 mm (H)
	Packaging Dimensions	1455 mm (L) x 750 mm (W) x 860 mm (H)
	Ground Clearance	140 mm
Performance	Maximum Working Slope	20°
	Maximum Incline Achievable	25° – 30°
	Forward Speed (High / Low)	5.4 km/h / 3.2 km/h
	Reverse Speed (High / Low)	2.7 km/h / 1.6 km/h
	Operational Run Time	1.5 to 2 Hours (From Full Charge)
	Maximum Incline Achievable	25° – 30°
Motor & Electrical	Motor Type	Brushless DC Motor (Forward & Reverse)
	Motor Power (Rated / Max)	0.8 kW / 2.4 kW
	Rated RPM	3200 r/min
	Voltage	60V
	Battery Capacity	20 Ah (Lead-Acid)
	Controller Model	WM-KD26-001
	Charger Input / Power	220V / 500W
	Charge Time	6 to 8 Hours (From Empty)
	Maximum Incline Achievable	25° – 30°
Drive System & Tracks	Transmission Type	Motor-Transmission-Track (High & Low Speed)
	Gearbox Oil Capacity	2 Litres (Sold Separately)
	Brake System	Mechanical / Arrester
	Track Contact Length	640 mm
	Track Center to Center	410 mm
	Overall Track Width	560 mm
	Track Specification	160 x 60 x 37 (Width x Pitch x Links)

2.2 Machine Components

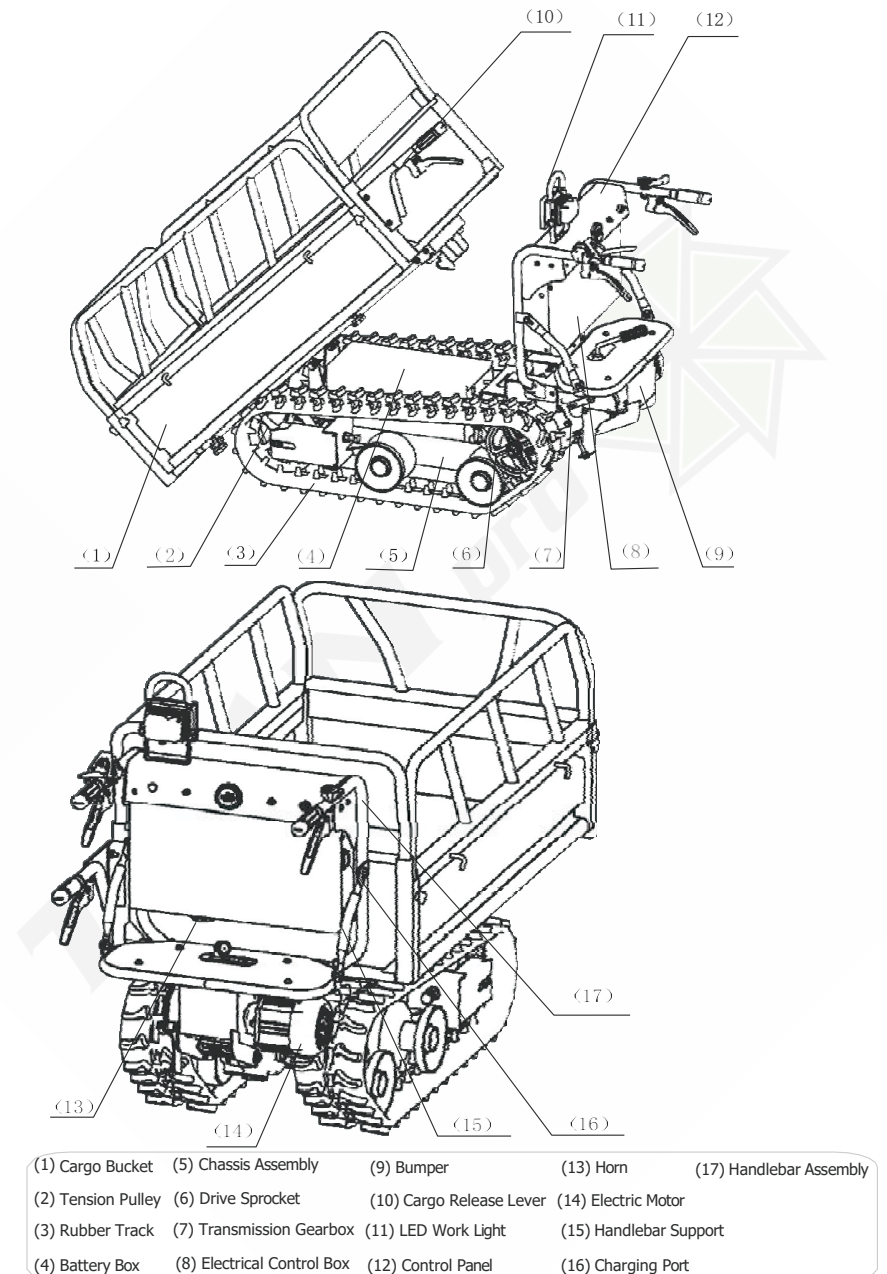

2.3 Controls Overview

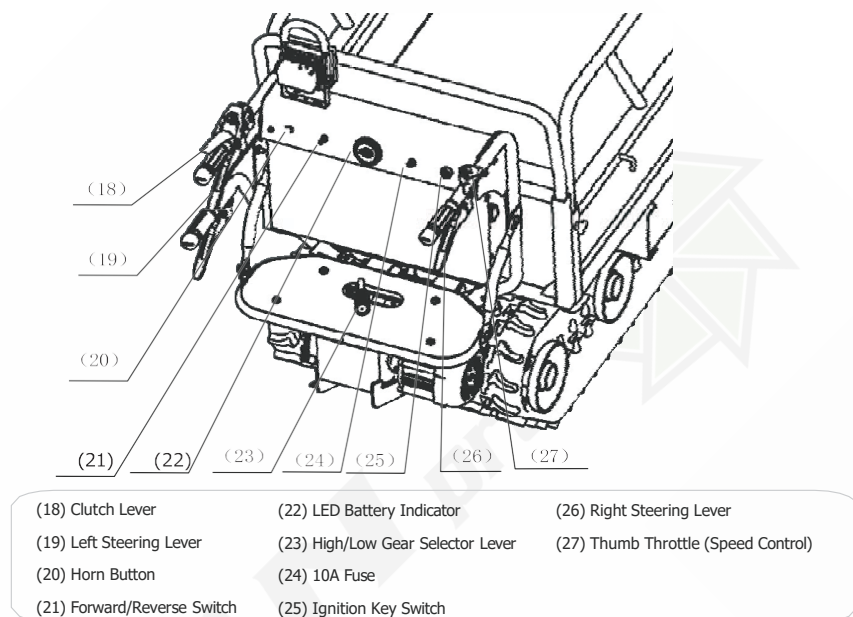

2.4 Circuit Diagram

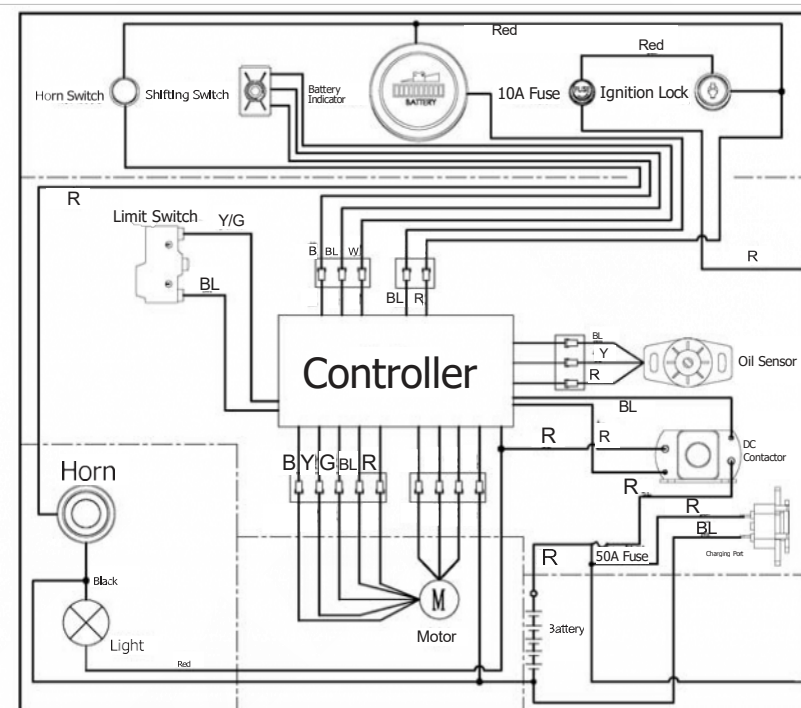

WIRE COLOUR

BL= Black R= Red
B= Blue W= White
Y= Yellow G= Green

3. INTENDED USE

The Mule TPM250E is designed for short-distance material transport across challenging terrain, including steep slopes, hills, and uneven ground.

Please Note: This machine is designed for off-road use only. It is not road legal and must not be operated on public roads, pavements, or verges.

4. ASSEMBLY

4.1 Unpacking

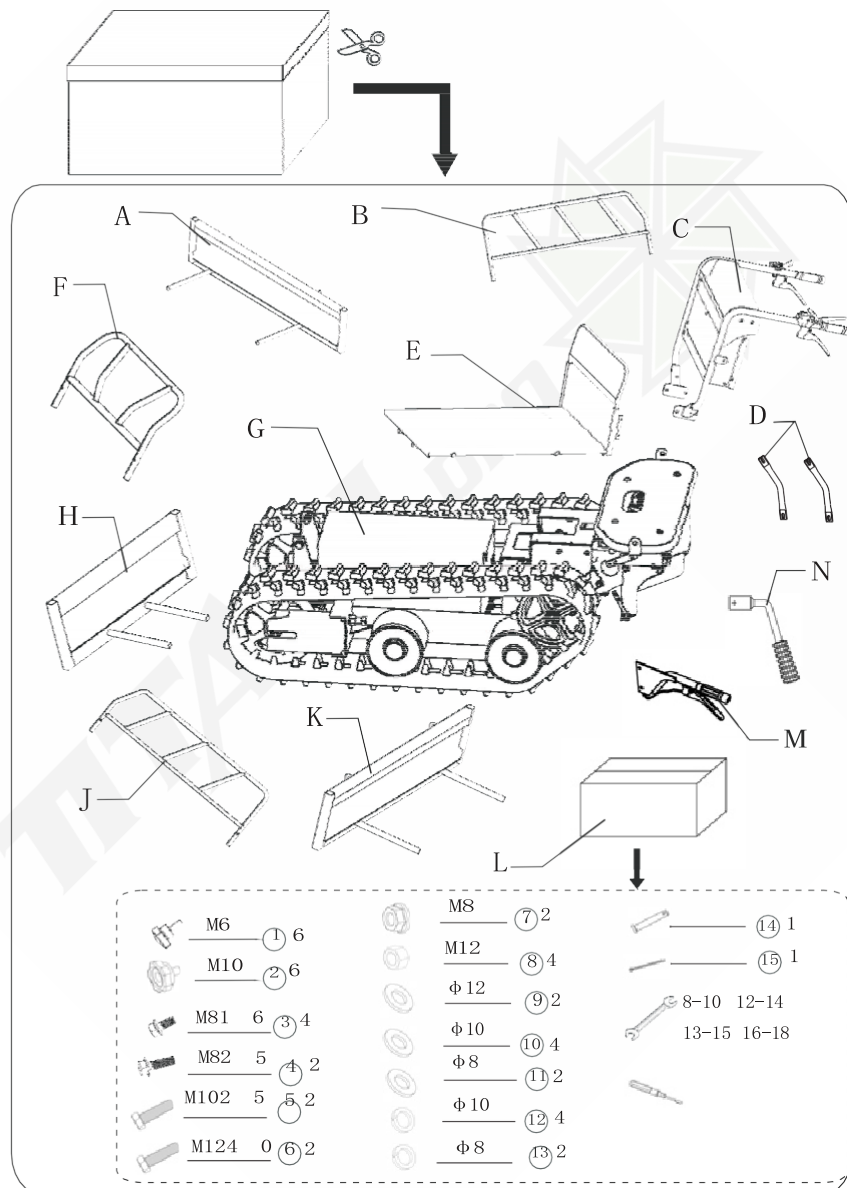

4.2 Assembly Instructions

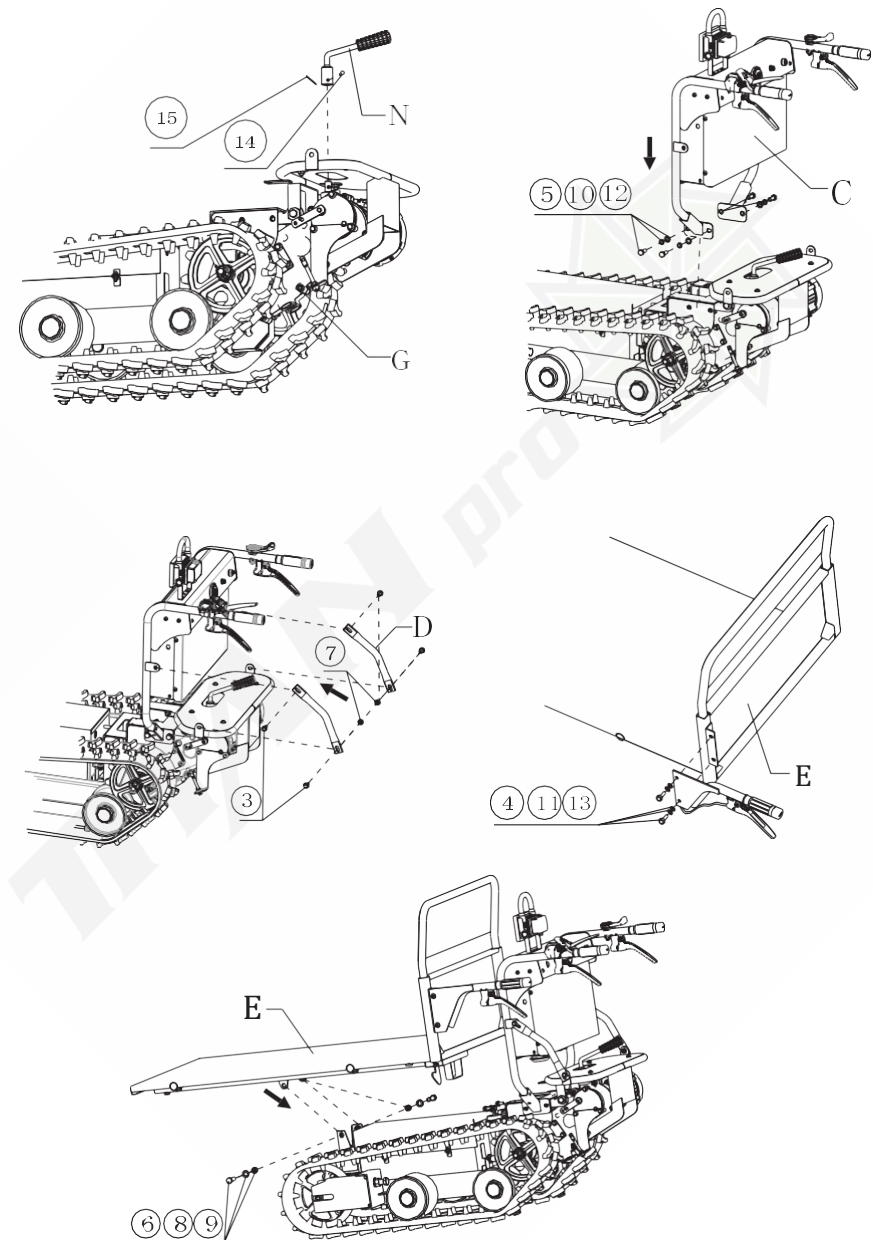

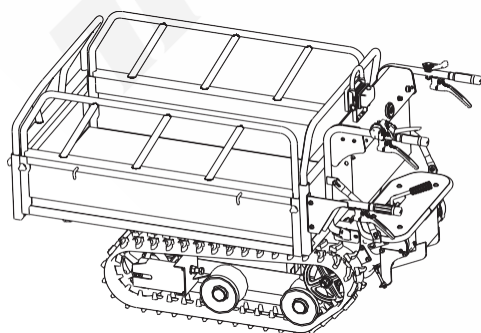
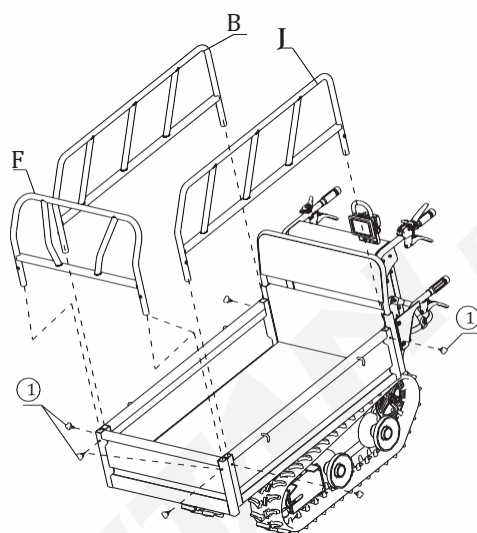
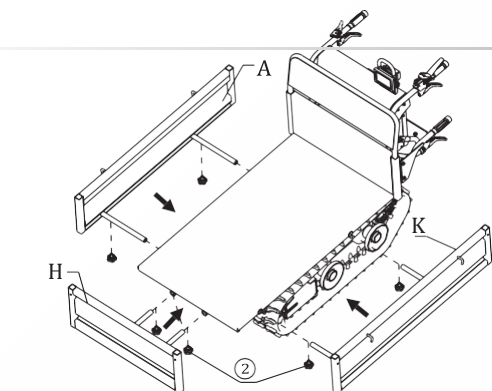

5. Operating Instructions

5.1 Pre-Start Checks

Perform the following checks before every use to ensure the machine is safe to operate:

1. Hardware & Wiring
 - Inspect all nuts, bolts, and fasteners to ensure they are tightened securely.
 - Check that all electrical wiring is intact, with no exposed wires or loose connections.
2. Controls Inspection
 - Inspect all nuts, bolts, and fasteners to ensure they are tightened securely.
 - Check that all electrical wiring is intact, with no exposed wires or loose connections.
3. Gear Selection
 - Ensure the Brake, Steering Levers, and Clutch Lever move freely and return to their neutral positions.
 - Check that the operating switches (Forward/Reverse, Speed Control) are functioning correctly.
4. Transmission Oil Check
 - **Note: The machine is shipped without oil. You must fill the gearbox before first use.**
 - Oil Type: EP80W-90 GL-5 • Capacity: 2 Litres
 - Instructions: Add oil through the transmission fill port (Port A). Check the dipstick/sight glass to ensure the oil level is sitting between the Minimum (Lv1) and Maximum (Lv2) marks.

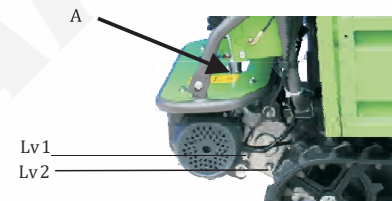

5.2 Starting

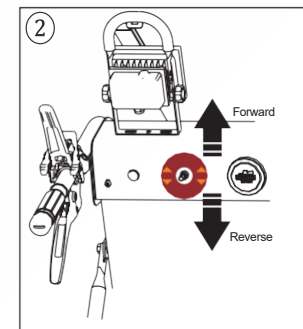
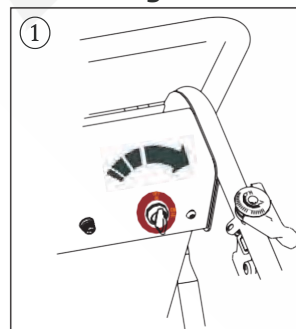

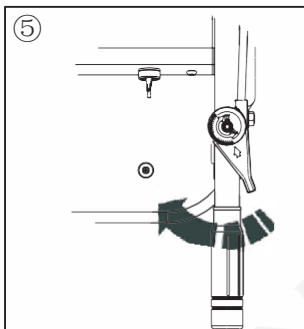
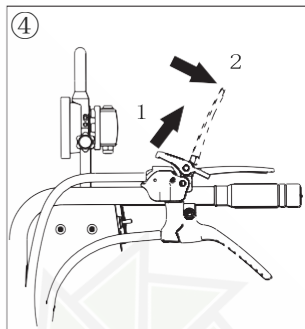
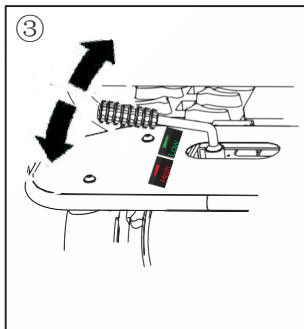

! WARNING

Ensure the surrounding area is clear before starting. **High-speed reversing is strictly prohibited.**

5.3 Operation

Stopping The Machine

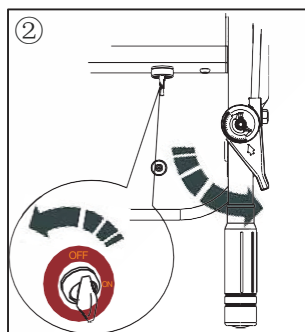
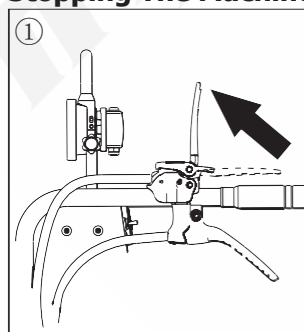

Gear Shifting

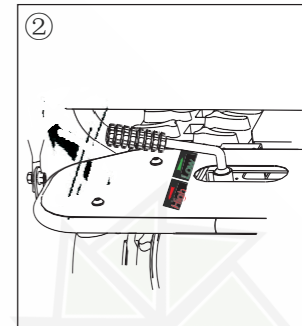
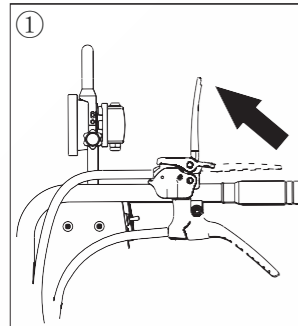

! NOTICE

To prevent gearbox damage, stop fully before shifting.

Steering

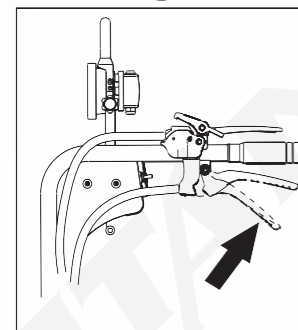

Unloading

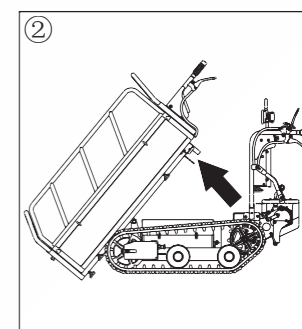
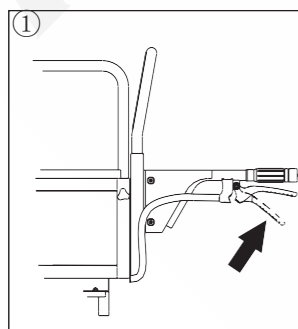

6. MAINTENANCE

6.1 Routine Inspection

System	Inspection Item	Before Use	Every Month	Every Year
Rubber Tracks	Visual Inspection (Cuts, cracks, wear)	✓	✓	✓
	Track Tension Check (Adjust if loose)	✓	✓	✓
	Track & Roller Mounting Bolts (Check tightness)	✓	✓	✓
Transmission	Operation Check (Abnormal noise, heat, or gear slippage)	✓	✓	✓
	Check for Oil Leaks		✓	✓
Electrical System	Motor Condition (Abnormal noise or overheating)		✓	✓
	Wiring Harness (Check for broken wires or loose connections)		✓	✓
Braking System	Brake Function Test (Ensure machine stops effectively)	✓	✓	✓
	Parking Brake Hold Test (Verify holding power on slope)		✓	✓
Controls & Steering	Steering Operation (Smoothness / No strange noise)	✓	✓	✓
	Gear Selector Lever (Moves smoothly)	✓	✓	✓
	Control Cables (Check for damage or detachment)		✓	✓
Sprockets & Idlers	Visual Inspection (Drive Sprocket & Idler Wheel)	✓	✓	✓
	Mounting Bolts (Check for broken or loose bolts)	✓	✓	✓
	Axle Shafts (Check for deformation/bending)	✓	✓	✓
	Axle Seals (Check for oil leaks)		✓	✓
Chassis & Body	Frame & Bolts (Check condition, cracks, and tightness)		✓	✓
Cargo Hopper/Skip	Tipping Mechanism (Operates smoothly)		✓	✓
	Cargo Door / Latches (Open and close correctly)		✓	✓
	Skip Condition (Check for cracks or impact damage)		✓	✓
Safety Labels	Safety Decals (Check they are present and legible)	✓	✓	✓

! WARNING

- ◆ **Stop the machine and remove the ignition key** before starting any maintenance.
- ◆ **Gearbox and electrical repairs** must be carried out by an authorised dealer or a qualified technician.

! NOTICE

Always use genuine replacement parts supplied by the manufacturer.

6.2 Transmission Oil Change

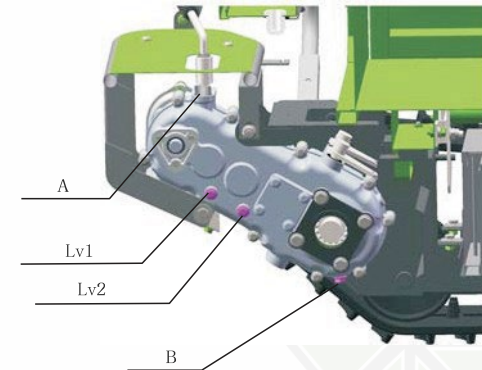

Perform this procedure while the gearbox is still warm to ensure the old oil drains effectively.

1. **Drain:** Place a suitable oil tray under the gearbox. Remove the **Filler Plug (A)** and the **Drain Bolt (B)** to release the oil.
2. **Seal:** Once fully drained, reinstall the **Drain Bolt (B)** and tighten it securely.
3. **Fill:** Pour **2 Litres** of recommended oil (15W-40) into the gearbox through **Port A**.
4. **Check Level:** Verify the oil level is correct. It should sit between the **Lv1** (Minimum) and **Lv2** (Maximum) marks on the dipstick.
5. **Close:** Reinstall the **Filler Plug (A)** and tighten securely.

7. TROUBLESHOOTING

Problem	Possible Cause	Solution
Machine Will Not Move	Battery is flat or voltage is too low.	Recharge the battery immediately.
	Fuse is blown.	Replace with a new 10A Fuse.
	Gear Selector Lever is not fully engaged.	Ensure the lever is clicked fully into High or Low gear.
	Throttle is not in the neutral (zero) position at startup.	Ensure throttle is fully released. Adjust throttle cable if necessary.
	Brake is seized or locked on.	Adjust the brake mechanism to release drag.
	Safety/Clutch Switch is not engaging.	Adjust the clutch cable tension to activate the switch.
	DC Contactor (Relay) failure.	Repair or replace the contactor (Contact Dealer).
Braking Issues	Motor failure.	Repair or replace the motor (Contact Dealer).
	Brake cables are poorly adjusted.	Adjust the brake cable tension.
	Water has entered the brake drum/mechanism.	Operate at low speed and apply brakes repeatedly to dry them out.
Track Issues	Machine is overloaded.	Reduce the load to within the rated capacity (220kg).
	Rubber track is snapped or damaged.	Replace the track.
Steering Issues	Track tension is too loose (slipping).	Adjust the idler wheel tensioner.
	Steering cable is broken.	Replace the steering cable.
Steering Issues	Steering lever is broken.	Replace the steering lever.
	Cable has disconnected from the steering arm.	Reconnect and secure the cable.
	Steering is difficult or unresponsive.	Machine is moving too fast.

8. TRANSPORT & STORAGE

8.1 Transporting the Machine



WARNING

1. **Prepare the Area:** Ensure the loading vehicle/trailer is on a flat, level surface and its wheels are chocked.
2. **Load Carefully:** Drive the machine slowly and steadily up the loading ramps. Do not steer sharply on ramps.
3. **Secure the Load:** Once positioned, stop the machine and remove the key. **Chock the rubber tracks** to prevent movement and secure the machine to the vehicle using heavy-duty **ratchet straps**.

8.2 Storage



NOTICE

To prevent rust and degradation:

- Store the machine in a dry, sheltered environment.
- Thoroughly clean the machine and tighten all fasteners before storage.
- Perform a final maintenance check as per Section 6.

Storage Procedures

1. **Clean:** Wash the machine thoroughly to remove mud and debris. Dry completely.
2. **Transmission:** Drain old gearbox oil and refill with fresh oil to protect internal gears from corrosion.
3. **Battery:** Disconnect the battery cables to prevent power drain. Insulate the cable ends with electrical tape.
4. **Electrical Contacts:** Apply a thin coat of **Petroleum Jelly (Vaseline)** or dielectric grease to exposed electrical terminals to prevent corrosion.
5. **Cover:** Cover the machine with a breathable sheet to protect it from dust and moisture.

**NOTICE**

Do not wash electrical components with water. Avoid using hoses or pressure washers on the control panel, motor, or wiring. Use a damp cloth only to prevent damage to the electrical system.

9. WEAR PARTS LIST

	Code	Name
1	GB/T3452.1-2005	O Ring 65X2.65
2	GB/T3452.1-2005	O Ring 10.6X1.8
3	GB/T9877-2008	Oil Seal B15267
4	GB/T9877-2008	Oil Seal B25477
5	GB/T9877-2008	Oil Seal B30527
6	JB/T982-77	Gasket 10
7	JB/T982-77	Gasket 8
8	11.159.030.0001	Brake Board
9	11.120.074.2000	Oil Seal 305518
10	11.120.025.5000	Oil Seal FB17337
11	11.108.999.5000	Washer
12	11.101.005.0050	Clutch Handle
13	11.101.005.0101	Turning Clutch Handle
14	11.159.088.0110	Horn
15	11.159.087.1010	Light
16	11.159.089.0310	Board
17	11.159.087.0610	Bumper



UKCA DECLARATION OF CONFORMITY

We Titan Pro Ltd - DT11 7FP (Importer) declare that the product:

Designation: Electric Tracked Barrow Transporter Dumper

Model(s): TPM250E

Rated Power: 800W

Complies with the following machinery directives:

2006/42/EC – Machinery Directive

The conformity assessment procedure followed was in accordance with: EN ISO 12100:2010, EN ISO 3691-5:2015, EN 1175-1:1998/A1: 2010

Notified Bodies

TÜV SÜD Product Service GmbH

Address(es)

Ridlerstraße 65, 80339 München, Germany

Authorised Signatory & Technical File Holder

Date:

24/02/2021

Signature:

Name: Mr. Charles Abbott

Position: Director

Company: Titan Pro Ltd

Address

Unit 11 Glenmore Business Park, Wend-Al Road, Blandford Forum, Dorset,
DT11 7FP